

Diamond ISO/British Standard Carbon Steel Chain

Diamond ISO/British Standard carbon steel chain is manufactured to ISO standards (IS 606, BS228, DIN 8187) for dimensions, interoperability, and sprocket fit. Connecting links are spring clip type for sizes up to DMD-16B, and cotter type for sizes DMD-20B and up.

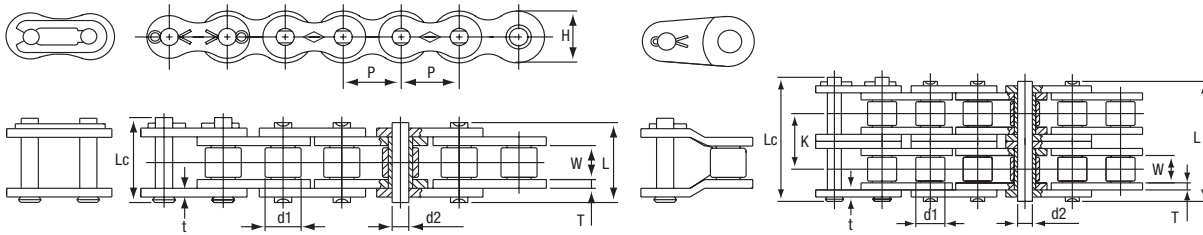

Diamond Part Number	Pitch (P)	Roller Width (W)	Roller Diameter (d1)	Pin Diameter (d2)	Roller Link Plate Thickness (T)	Pin Link Plate Thickness (t)	Chain Width, Cottered (Lc)	Chain Width Riveted (L)	Center to Center (K)	Max Link Plate Height (H)	Avg. Weight	Avg. Tensile Strength
	mm in	mm in	mm in	mm in	mm in	mm in	mm in	mm in	mm in	mm in	kg/m lb/ft	kN lbf
DMD-05B-1	8.00 0.315	3.00 0.118	5.00 0.197	2.31 0.091	0.90 0.035	0.90 0.035	11.70 0.461	8.60 0.339	-	7.10 0.280	0.09 0.063	5.88 1.323
DMD-06B-1	9.53 0.375	5.72 0.225	6.35 0.250	3.28 0.129	1.40 0.055	1.10 0.043	16.80 0.661	13.50 0.531	-	8.20 0.323	0.41 0.277	10.79 2.425
DMD-06B-2	9.53 0.375	5.72 0.225	6.35 0.250	3.28 0.129	1.40 0.055	1.10 0.043	27.10 1.067	23.80 0.937	10.24 0.403	8.20 0.323	0.79 0.528	18.63 4.189
DMD-06B-3	9.53 0.375	5.72 0.225	6.35 0.250	3.28 0.129	1.40 0.055	1.10 0.043	37.30 1.469	34.00 1.339	10.24 0.403	8.20 0.323	1.22 0.818	27.95 6.283
DMD-08B-1	12.70 0.500	7.75 0.305	8.51 0.335	4.45 0.175	1.50 0.059	1.50 0.059	20.70 0.815	17.00 0.669	-	11.80 0.465	0.70 0.469	19.12 4.299
DMD-08B-2	12.70 0.500	7.75 0.305	8.51 0.335	4.45 0.175	1.50 0.059	1.50 0.059	34.90 1.374	31.00 1.220	13.92 0.548	11.80 0.465	1.33 0.897	37.76 8.488
DMD-08B-3	12.70 0.500	7.75 0.305	8.51 0.335	4.45 0.175	1.50 0.059	1.50 0.059	48.80 1.921	44.90 1.768	13.92 0.548	11.80 0.465	2.00 1.343	56.63 12.732
DMD-10B-1	15.88 0.625	9.65 0.380	10.16 0.400	5.08 0.200	1.70 0.067	1.70 0.067	23.70 0.933	19.60 0.772	-	14.70 0.579	0.91 0.609	27.46 6.173
DMD-10B-2	15.88 0.625	9.65 0.380	10.16 0.400	5.08 0.200	1.70 0.067	1.70 0.067	40.30 1.587	36.20 1.425	16.59 0.653	14.70 0.579	1.80 1.210	54.82 12.323
DMD-10B-3	15.88 0.625	9.65 0.380	10.16 0.400	5.08 0.200	1.70 0.067	1.70 0.067	56.90 2.240	52.80 2.079	16.59 0.653	14.70 0.579	2.71 1.824	82.23 18.485
DMD-12B-1	19.05 0.750	11.68 0.460	12.07 0.475	5.72 0.225	1.80 0.071	1.80 0.071	27.30 1.075	22.70 0.894	-	16.10 0.634	1.13 0.760	32.85 7.385
DMD-12B-2	19.05 0.750	11.68 0.460	12.07 0.475	5.72 0.225	1.80 0.071	1.80 0.071	46.80 1.843	42.20 1.661	19.46 0.766	16.10 0.634	2.27 1.526	63.74 14.330
DMD-12B-3	19.05 0.750	11.68 0.460	12.07 0.475	5.72 0.225	1.80 0.071	1.80 0.071	65.50 2.579	60.90 2.398	19.46 0.766	16.10 0.634	3.42 2.301	95.62 21.495
DMD-16B-1	25.40 1.000	17.02 0.670	15.88 0.625	8.28 0.326	4.00 0.157	3.20 0.126	41.50 1.634	36.10 1.421	-	21.00 0.827	2.69 1.807	73.55 16.535
DMD-16B-2	25.40 1.000	17.02 0.670	15.88 0.625	8.28 0.326	4.00 0.157	3.20 0.126	73.40 2.890	68.00 2.677	31.88 1.255	21.00 0.827	5.30 3.559	147.10 33.069
DMD-16B-3	25.40 1.000	17.02 0.670	15.88 0.625	8.28 0.326	4.00 0.157	3.20 0.126	105.30 4.146	99.90 3.933	31.88 1.255	21.00 0.827	7.91 5.312	220.65 49.604
DMD-20B-1	31.75 1.250	19.56 0.770	19.05 0.750	10.19 0.401	4.70 0.185	4.70 0.185	49.30 1.941	43.20 1.701	-	26.40 1.039	3.92 2.637	106.40 23.920
DMD-20B-2	31.75 1.250	19.56 0.770	19.05 0.750	10.19 0.401	4.70 0.185	4.70 0.185	85.80 3.378	79.70 3.138	36.45 1.435	26.40 1.039	7.71 5.178	212.80 47.840
DMD-20B-3	31.75 1.250	19.56 0.770	19.05 0.750	10.19 0.401	4.70 0.185	4.70 0.185	122.10 4.807	116.00 4.567	36.45 1.435	26.40 1.039	11.51 7.735	319.21 71.760
DMD-24B-1	38.10 1.500	25.40 1.000	25.40 1.000	14.63 0.576	6.30 0.248	6.30 0.248	60.00 2.362	53.40 2.102	-	33.40 1.315	7.06 4.744	178.48 40.124
DMD-24B-2	38.10 1.500	25.40 1.000	25.40 1.000	14.63 0.576	6.30 0.248	6.30 0.248	107.60 4.236	101.00 3.976	48.36 1.904	33.40 1.315	13.95 9.374	356.96 80.248
DMD-24B-3	38.10 1.500	25.40 1.000	25.40 1.000	14.63 0.576	6.30 0.248	6.30 0.248	156.60 6.165	150.00 5.906	48.36 1.904	33.40 1.315	20.86 14.017	535.44 120.372
DMD-28B-1	44.45 1.750	30.99 1.220	27.94 1.100	15.90 0.626	7.80 0.307	7.80 0.307	72.50 2.854	65.10 2.563	-	37.00 1.457	8.57 5.758	225.55 50.706
DMD-28B-2	44.45 1.750	30.99 1.220	27.94 1.100	15.90 0.626	7.80 0.307	7.80 0.307	131.40 5.173	124.00 4.882	59.56 2.345	37.00 1.457	17.23 11.576	451.11 101.413
DMD-28B-3	44.45 1.750	30.99 1.220	27.94 1.100	15.90 0.626	7.80 0.307	7.80 0.307	191.40 7.535	184.00 7.244	59.56 2.345	37.00 1.457	25.30 16.999	676.66 152.119
DMD-32B-1	50.80 2.000	30.99 1.220	29.21 1.150	17.81 0.701	7.30 0.287	7.30 0.287	75.30 2.965	67.40 2.654	-	42.20 1.661	9.46 6.357	279.49 62.832
DMD-32B-2	50.80 2.000	30.99 1.220	29.21 1.150	17.81 0.701	7.30 0.287	7.30 0.287	133.90 5.272	126.00 4.961	58.55 2.305	42.20 1.661	18.63 12.520	558.98 125.664
DMD-32B-3	50.80 2.000	30.99 1.220	29.21 1.150	17.81 0.701	7.30 0.287	7.30 0.287	194.90 7.673	187.00 7.362	58.55 2.305	42.20 1.661	27.93 18.768	838.47 188.496